



BURGESS-MANNING

Burgess-Manning, Inc., Subsidiary of Nitram Energy, Inc.

227 Thorn Avenue, Orchard Park, NY 14127

Phone: (716) 662-6540 Fax: (716) 662-6548 Website: www.burgess-manning.com

MODEL BMBAI - Blower Intake Silencer

Burgess-Manning Below Transition Speed Blower Intake Silencer

Description:

Burgess-Manning chambered reactive type blower intake silencers are specifically designed to provide ideal noise reduction at blower speeds below transition speed.

Features:

- Noise reduction up to 35 dB
- Economically priced
- Long service life
- All welded steel construction for explosion resistant service

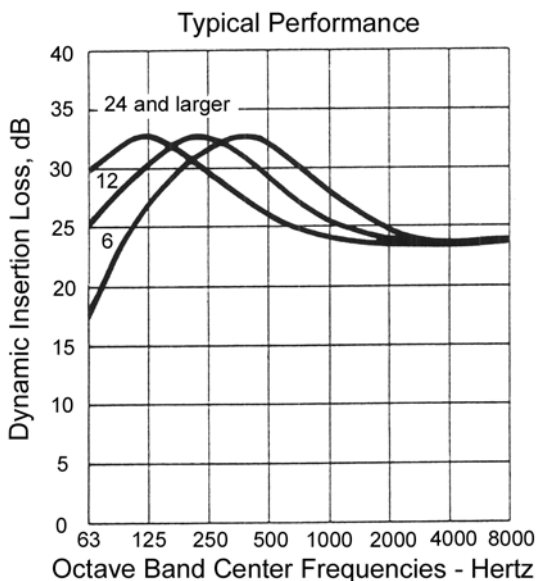

Specifications:

Maximum Noise Attenuation:	35 dB
Typical Sizes:	1" - 24" Larger Sizes Available Upon Request
Standard End Connections:	NPT or 125# ANSI Flanged
Standard Material of Construction:	Carbon Steel
Finish:	Prime Coated Exterior

Figure 1.0

Typical Burgess-Manning reactive type silencer

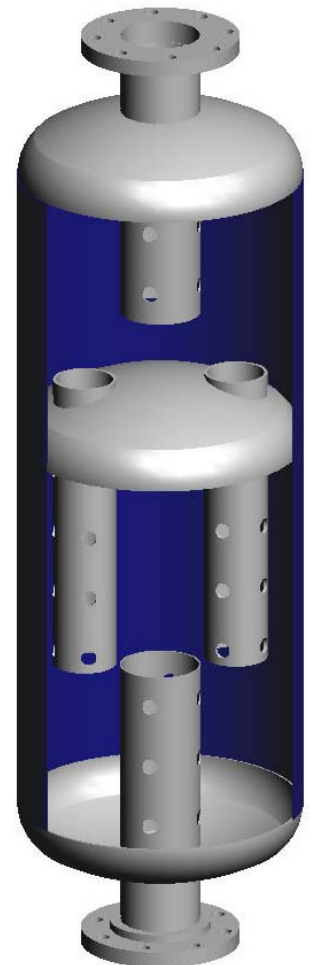

Theory of Operation:

The Burgess-Manning patented principle used in the design of Burgess-Manning silencers involves passing gas flow through snubbing chambers. These snubbing chambers house an arrangement of ported tubes, which attenuate the noise to smooth, quiet flow.

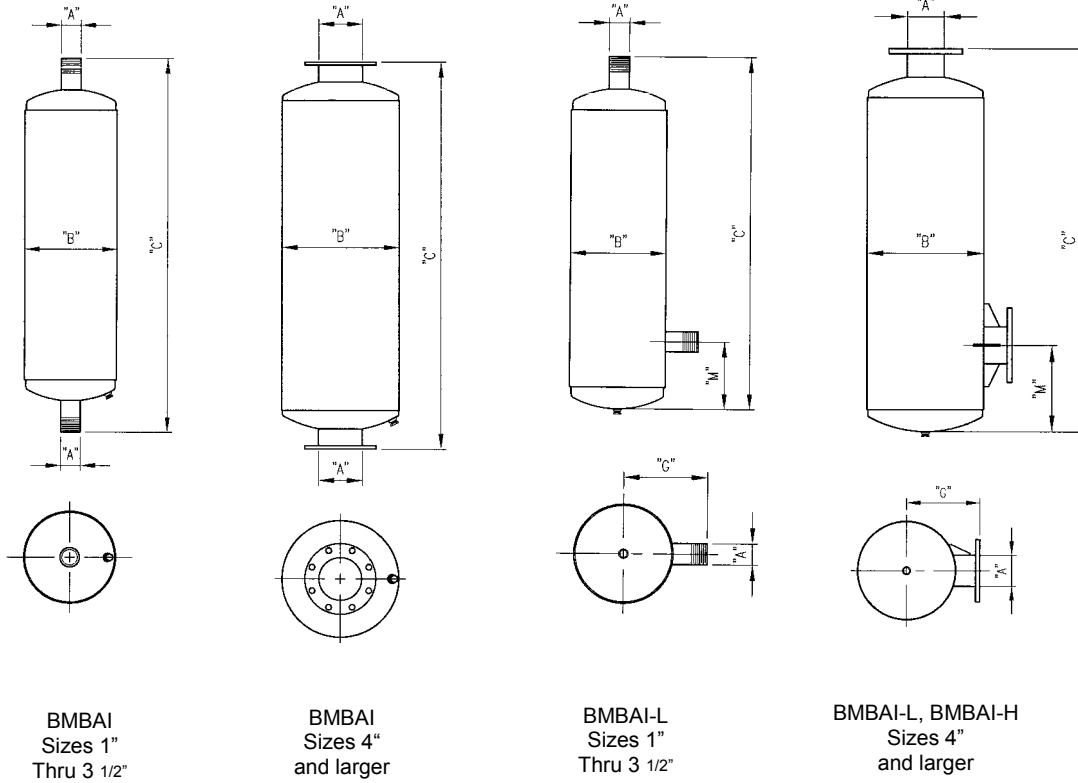

Catalog Number	Dimensions in Inches									Estimated Weight in lbs.		
	All Models		BMBAI	BMBAI-L		M						
	A	B	C	C	G	BMBAI-L		BMBAI-H		BMBAI	BMBAI-L	BMBAI-H
						Min.	Max.	Min.	Max.			
BMBAI-1	1	4 1/2	23	21	4 1/4	2	—	—	—	8	8	—
BMBAI-1.5	1 1/2	6 1/2	24	21	5 1/2	4	—	—	—	12	12	—
BMBAI-2	2	8	32	30	7	4	12 1/2	—	—	23	23	—
BMBAI-2.5	2 1/2	10	33	31	8	4 1/2	13	—	—	32	32	—
BMBAI-3	3	10	47	43	9	5	19	—	—	53	53	—
BMBAI-3.5	3 1/2	12	48	44	10	5 1/2	19	—	—	65	65	—
BMBAI-4	4	14	52	50	10	6	21	—	—	99	99	—
BMBAI-5	5	16	59	57	11	7	24	—	—	145	145	—
BMBAI-6	6	18	72	70	12	8	31	—	—	195	195	—
BMBAI-8	8	22	92	89	15	10	46	47	82	470	470	465
BMBAI-10	10	26	117	114	18	12	58	55	100	760	760	748
BMBAI-12	12	30	130	127	21	14	58	62	106	1,200	1,200	1,158
BMBAI-14	14	36	169	166	22	15	87	75	147	1,240	1,240	1,575
BMBAI-16	16	42	183	179	25	17	87	89	159	1,690	1,690	2,300
BMBAI-18	18	48	184	181	28	19	87	91	159	2,545	2,545	2,775
BMBAI-20	20	54	192	189	31	21	92	93	165	2,945	2,945	3,300
BMBAI-22	22	60	202	198	35	23	92	101	171	4,230	4,230	4,575
BMBAI-24	24	60	238	234	35	24	115	114	205	5,060	5,060	5,375

Notes: - Flanges are drilled to match 125 lb. American Standard Flanges
 - Larger Units available upon request
 - Specifications subject to change without notice